

REMOTE DESIGN AND QUOTE SERVICE GUIDE FOR



**We'll get your 2020 designs and quotes to you in just
two days.**

HOW IT WORKS

INITIAL DESIGN

- 1 Get the kitchen measurements ready. Then sketch where the appliances and cabinets go. Here's a good example of what works best:

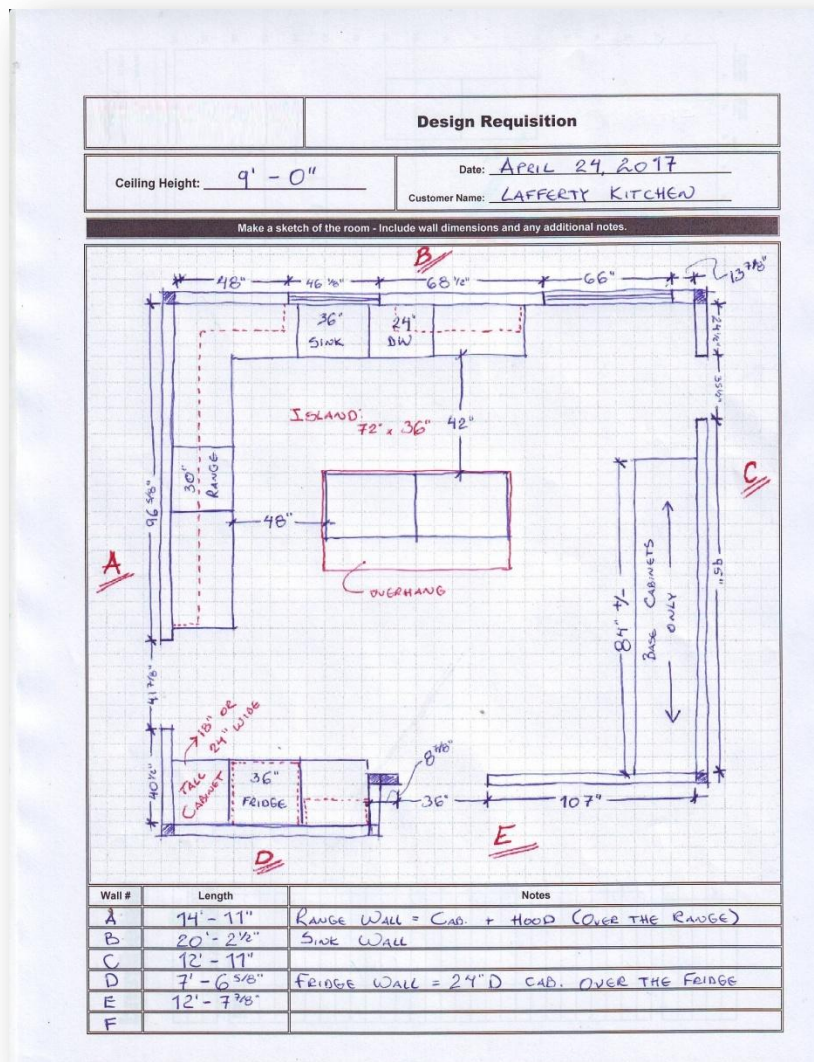

2 Get the bathroom, mudroom, etc. measurements ready. We'd like cabinet sizing and codes for these areas. Here's a good example of what your designer can work with:

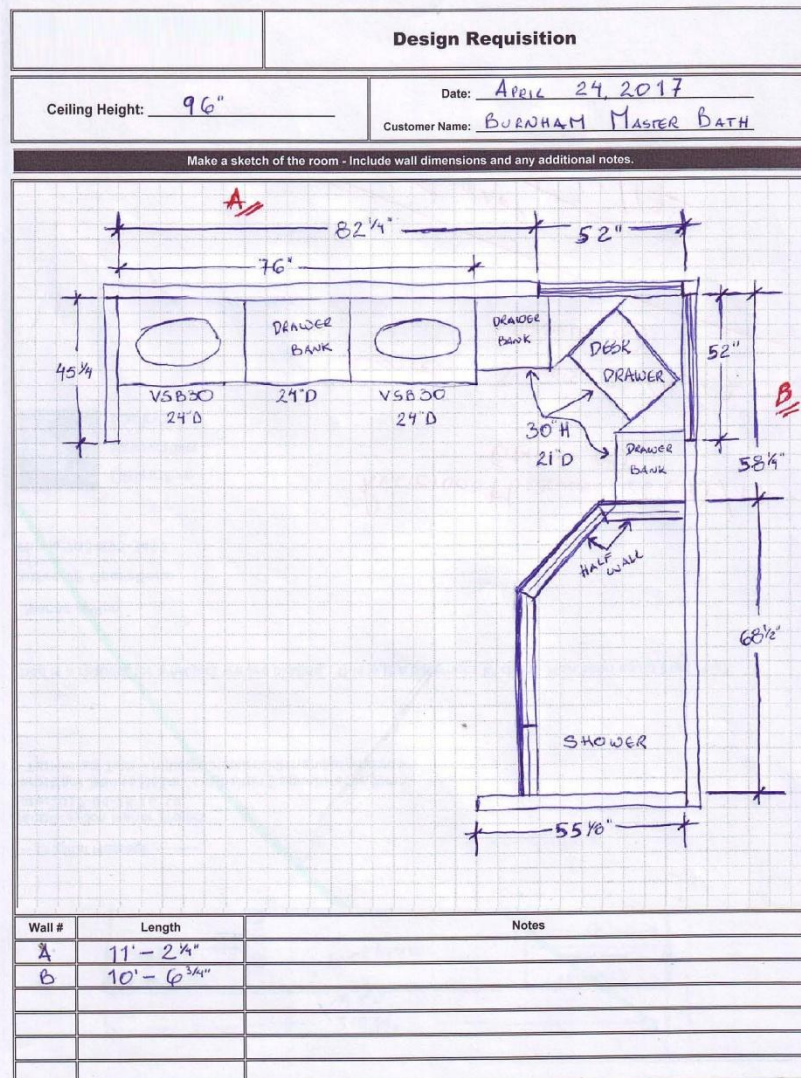

3 Either take a smart phone photo or scan the measurements.

4 Now begin your online design submittal by clicking:
designs@masterkd.com.

5 Click which cabinet brand to design.

6 Complete the online submittal for all the rooms to design.

7 Upload the measurements and cabinet sketches and click **SUBMIT**

8 You'll receive a confirmation with both the design completion date and a design registration number.

9 In two days you'll receive a full design and quote package. The 2020 file is also included for those who'd like to continue designing on their own. Here's what's included in the design package: (color drawings, floor plan, wall views with measurements and quote)

Standard Design Package

18 Drawing 1
DRAFT - UNREPRESENTATIVE

18 Drawing 1
DRAFT - UNREPRESENTATIVE

18 Drawing 1
DRAFT - UNREPRESENTATIVE

18 Drawing 1
DRAFT - UNREPRESENTATIVE

18 Drawing 1
DRAFT - UNREPRESENTATIVE

18 Drawing 1
DRAFT - UNREPRESENTATIVE

CATALOG KCCAN62_1

Supplier: KitchenCraft Canada

Item	Qty	Material Code	Description	Selected Door Style	Price
1	1	TD304243	Tall Drawer 30w 18d 82h Fwd		2,353.00
1.1	1	S2	Installed Slide Out Tray (2 Tray)		422.00
2	1	T33242	Tall 33w 24d 92h		2,299.00
*2.1	1	FEL	Finished End Left		215.00
3	1	T33242	Tall 33w 24d 92h		2,299.00
4	1	W3036	Wall 30w 36h		794.00
*4.1	1	M4	Matching Veneer Inset (+N)		475.40
4.2	2	M4L	Matching Veneer Inset (+N)		352.00
5	1	W3021	Wall 30w 21h		645.00
6	1	W3036	Wall 30w 36h		841.00
*6.1	1	M4	Matching Veneer Inset (+N)		554.60
6.2	2	M4L	Matching Veneer Inset (+N)		382.00
7	1	W3321	Wall 33w 21h		684.00
8	1	BC3048	Base Drawer 30w 48 3-drawer		1,176.00
*8.1	1	FEB	Finished End Bath		278.00
8.2	2	WC115	Wood Cutlery Tray 15"W		470.00
9	1	BC333V	Base Drawer 33w 3-drawer		1,129.00
*9.1	1	FEB	Finished End Bath		278.00
10	1	F396	Soft Close Overlay Filler 3w 96h		195.00
11	1	F321	Overlay Filler 3w 21h		45.00
12	2	TK96	ToeKick 96		150.00
13	4	MSACM9P	Medium 60 Ang Draw Mid 96 no steel		790.00
14	4	88M296	Sub Mounting 296		840.00
15	2	TWELR96	Traditional Wood Edge Light Rail 96		170.00
Cabinets subtotal					17,123.00
Charges					
*15	1	AL	Albacor (+N)		1,591.86
Phenams total					1,591.86
*17	24	SC07-H4NG2	Soft Close Upgrade		483.00
*18	10	H4OCB	White Int - Hardwood Overlay - Full Ext w 98 Close		0.00
Cabinets net total					18,197.86

CATALOG KCCAN62A_1

Supplier: KitchenCraft Canada

Item	Qty	Material Code	Description	Selected Door Style	Price
24	1	BP4835	Base Panel 48w 30h		270.00
25	1	BC333V	Base Drawer 30w 3-drawer		1,095.00
26	1	BC333V	Base Drawer 30w 3-drawer		1,095.00
*28.1	1	FER	Finished End Right		136.00
27	1	BE36	Base Sink 36w		853.00
*27.1	1	FEL	Finished End Left		136.00
28	1	BP4835	Base Panel 48w 30h		270.00
29	1	BX312FH	Base 30w 120 Full Height		705.00
*29.1	1	FTK	Flush ToeKick		120.00
30	1	BX312FH	Base 30w 120 Full Height		705.00
*30.1	1	FTK	Flush ToeKick		120.00
31	1	BX312FH	Base 30w 120 Full Height		705.00
*31.1	1	FTK	Flush ToeKick		120.00
32	1	BX312FH	Base 30w 120 Full Height		705.00
*32.1	1	FTK	Flush ToeKick		120.00
33	3	F8M96	Furniture Base Moulding 96		327.00
34	1	TK96	ToeKick 96		78.00
Cabinets subtotal					7,500.00
Charges					
*35	1	NB	Nimbus (+N)		462.56
Phenams total					462.56
*36	10	SC07-H4NG2	Soft Close Upgrade		170.00
*37	6	H4OCB	White Int - Hardwood Overlay - Full Ext w 98 Close		0.00
Upcharges total					170.00
Charges total					632.56
Cabinets net total					8,132.56
Accessories					
*38	1	TK435	Touch Up Kit Nimbus (pc)		24.00
*39	6	ETV	Veneer Edge Tape 78 (pc)		340.00
Accessories subtotal					264.00
Charges					

QUOTE SUMMARY

KCCAN62_1 Net total: \$18,730.42

KCCAN62A_1 Net total: \$8,195.82

Quote total: \$26,926.24

Quote net total: **\$28,959.82**

Volume: 353.12 Weight: 135.00

Print date: 03/01/2017 Page 2/6

Print date: 03/01/2017 Page 4/6

Print date: 03/01/2017 Page 6/6

2 Option #2 - If the changes are simple, then just list them on the online submittal.

3 Begin your design changes by clicking: designs@masterkd.com.

4 Click: **DESIGN CHANGE ONLY** and enter the design number from the original design.

5 Upload any plans with design change notes and/or outline the changes on the submittal. Click the **SUBMIT** button.

6 You'll receive a confirmation with the design completion date.

7 In two days you'll receive a full design and quote package. The 2020 file is also included for those who'd like to continue designing on their own. Here's what's included in the design package: (color drawings, floor plan, wall views with measurements and quote)

The design package includes:

- 3D renderings of the kitchen and island.
- A detailed floor plan with dimensions.
- Three tables: a materials list, a quote summary, and a quote total.

CATALOG KOCARNA_1				CATALOG KOCARNA_1				QUOTE SUMMARY				
Supplier: KitchenCraft Canada				Supplier: KitchenCraft Canada				KOCARNA_1 Item total: \$15,165.00				
Wall Door: Soft Close Lagiplex				Wall Door: Soft Close Lagiplex				KOCARNA_1 Item total: \$6,195.00				
Drawer Front: White 66 - Hardwood Overlay - Full Ext w 66 Close				Drawer Front: White 66 - Hardwood Overlay - Full Ext w 66 Close				Quote total: \$21,360.00				
Door Pull: Door Pull				Door Pull: Door Pull				Quote net total: \$21,360.00				
Base Door: Base Door				Base Door: Base Door				Volume: 305.12				
Door Style: Door Style				Door Style: Door Style				Weight: 100.00				
Cabinets:				Cabinets:				Quote total: \$21,360.00				
1	1	T102020-0	Full Overlay 18x18 20x Full	2,000.00	24	1	SP4600	Base Panel 48x 36x	270.00			
11	1	02	Hardwood 18x18 24x 24 2 Top	402.00	25	1	02005V	Base Cabinet 24x 3x 6x	1,380.00			
2	1	T102040	Full Overlay 24x 24 2x	2,280.00	26	1	02005V	Base Cabinet 24x 3x 6x	1,380.00			
7	1	F01	Framed End Left	270.00	26.1	1	F08	Framed End Right	180.00			
3	1	T102040	Full Overlay 24x 24 2x	2,280.00	27	1	F08	Base End 24x	480.00			
4	1	00000	Wall 24x 36x	184.00	27.1	1	F01	Framed End Left	180.00			
7.1	1	W01	Melting Vessel 18x18 (24x)	475.40	28	1	SP4600	Base Panel 48x 36x	270.00			
4.3	2	W01	Melting Vessel 18x18	950.80	29	1	000219	Base 24x 12x Full Height	180.00			
5	1	00021	Wall 24x 36x	140.00	29.1	1	F7K	Flush Tapsink	120.00			
6	1	00000	Wall 24x 36x	184.00	30	1	000219	Base 24x 12x Full Height	180.00			
7.1	1	W01	Melting Vessel 18x18 (24x)	475.40	30.1	1	F7K	Flush Tapsink	120.00			
4.3	2	W01	Melting Vessel 18x18	950.80	31	1	000219	Base 24x 12x Full Height	180.00			
7	1	00021	Wall 24x 36x	140.00	31.1	1	F7K	Flush Tapsink	120.00			
8	1	02000	Base Cabinet 24x 3x 6x 4x 4x 4x 4x	1,170.00	32	1	000219	Base 24x 12x Full Height	180.00			
7.1	1	F08	Framed End Both	270.00	32.1	1	F7K	Flush Tapsink	120.00			
8.3	2	W0710	Wood Cabinet Tray 12x 12x	470.00	33	3	00060	Function Base Mounting 00	637.50			
9	1	02000	Base Cabinet 24x 3x 6x	1,170.00	34	1	T068	Tapsink 24	780.00			
7.1	1	F08	Framed End Both	270.00	34	1	T068	Tapsink 24	780.00			
10	1	F36	Just 24x 24x Overlay Filter 2x 2x 2x 2x	180.00	Cabinets subtotal:				3,980.00			
11	1	F20	Overlay Filter 2x 2x 2x	40.00	35	1	H0	Hardware (24x)	400.00			
12	2	T068	Tapsink 24	1560.00	36	1	000000	Hardware 24x	400.00			
13	4	000000	Melting Vessel 24x 24x 24x 24x 24x 24x 24x 24x	360.00	37	10	0071-0000	Soft Close Lagiplex	170.00			
14	4	000000	Soft Mounting 24x	360.00	37	1	000000	White 66 - Hardwood Overlay - Full Ext w 66 Close	0.00			
15	2	T068-00	Traditional round Edge Light Pull 24	170.00	Charges total:				170.00			
Charges:				11,120.00	Cabinets not total:				3,100.00			
718	1	AL	Hardware (24x)	1,071.00	Accessories:				2,420.00			
719	1	Hardware 24x	Hardware 24x	1,071.00	728	1	T068	Flush 24x 24x 24x 24x (24)	400.00			
710	24	0071-0000	Soft Close Lagiplex	402.00	729	1	ETV	Vertical Edge Tape 18 (24)	3.00			
719	10	000000	White 66 - Hardwood Overlay - Full Ext w 66 Close	0.00	Cabinets subtotal:				27.50			
Print date: 02/01/2017				Page 1/18	Print date: 02/01/2017				Page 4/18	Print date: 02/01/2017		Page 5/18

Contact us with any questions to:
designs@masterkd.com